



"Strong" on Service
P.O. Box 11 Brandon, FL 33509
Toll Free 800.752.1730
www.qualityprecast.com

ENGINEERING SPECIFICATIONS:

SAFE LOAD TABLE NOTES:

1. SAFE LOADS ARE TOTAL ALLOWABLE SUPERIMPOSED LOADS.
2. DESIGNER MAY EVALUATE CONCENTRATED LOADS FROM THE SAFE LOAD TABLES BY CALCULATING MAX. RESISTING MOMENT AND SHEAR AT d DISTANCE AWAY FROM THE FACE OF THE SUPPORT FOR THE LISTED SILLS.
3. SAFE LOADS ARE BASED ON 3/8" (MIN.) THICK FULL MOTAR (TYPE S) BED.

GENERAL NOTES:

1.) CODES

- 1.1 FLORIDA BUILDING CODE (5TH EDITION, 2014, RESIDENTIAL) SECTION R402.2
- 1.2 FLORIDA BUILDING CODE (5TH EDITION, 2014, BUILDING) SECTION 1901.2
- 1.3 BUILDING CODE REQUIREMENTS FOR REINFORCED CONCRETE (ACI 318-11).
- 1.4 AMERICAN SOCIETY OF CIVIL ENGINEERS MINIMUM DESIGN LOADS FOR BUILDINGS AND OTHER STRUCTURES (ASCE 7-10).

2.) CONCRETE:

- 2.1 CONCRETE COMPRESSIVE STRENGTH AT 28 DAYS = 4000 PSI
- 2.2 REINFORCING BARS:
 - 2.2.1 STEEL PLACED IN PRECAST SILL AT TIME OF FABRICATION ASTM A615 (GRADE 40) IS FOR HANDLING PURPOSES ONLY.
- 2.3 DETAIL REINFORCEMENT IN ACCORDANCE WITH ACI 315.
- 2.4 CONCRETING OPERATIONS SHALL COMPLY WITH ACI STANDARDS

3) MASONRY:

- 3.1 DESIGN AND CONSTRUCTION SHALL CONFORM TO THE SPECIFICATION OF THE NATIONAL CONCRETE MASONRY ASSOCIATION AND ACI 530-11.
- 3.2 MORTAR SHALL BE TYPE S.

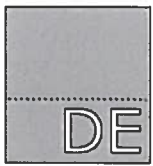

DANSOCO ENGINEERING, LLC
P.O. BOX 3400
Apollo Beach, Florida 33572
p. 813.645.0166
f. 813.645.7698
www.danscoengineering.com

REVISION:

DATE	DESCRIPTION

- CA 25948
- SAMUEL A. GREENBERG,
P.E. #34245
- HUY H. HUYNH,
P.E. #60122

QUALITY PRECAST COMPANY
P.O. BOX 11
Brandon, Florida 33509

SEP 28 2016

Del

ENGINEER SEAL

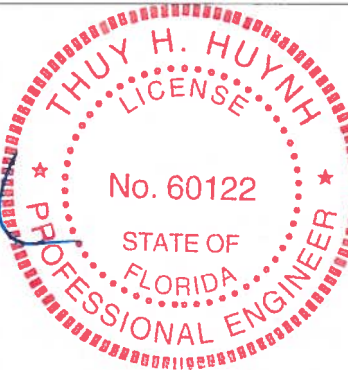

SHEET TITLE:
GENERAL NOTES

SHEET INFORMATION:

JOB NO.: 360950
DATE ISSUED: 9.27.16
DRAWN BY: JH
REVIEWED BY: TH

SK1



"Strong" on Service
 P.O. Box 11 Brandon, FL 33509
 Toll Free 800.752.1730
 www.qualityprecast.com

THRU WALL SILL (FOR TILE)				SAFE LATERAL CAPACITY (plf)
	TOTAL SPAN	TYPE	STEEL	
TW 19"	1' - 7'	PRECAST	--	650
TW 26-1/2'	2' - 2 1/2'	PRECAST	--	650
TW 31'	3' - 1'	PRECAST	#3	650
TW 48'	4' - 0'	PRECAST	#3	650
TW 53'	4' - 5'	PRECAST	#3	650
TW 74'	6' - 2'	PRECAST	#3	650

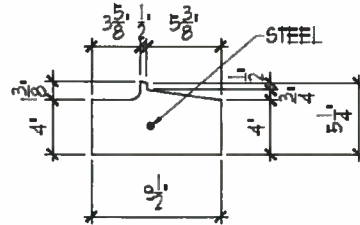

HURRICANE RESISTANT SILL				SAFE LATERAL CAPACITY (plf)
	TOTAL SPAN	TYPE	STEEL	
HTW 19"	1' - 7'	PRECAST	--	650
HTW 26-1/2'	2' - 2 1/2'	PRECAST	--	650
HTW 31'	3' - 1'	PRECAST	#3	650
HTW 48'	4' - 0'	PRECAST	#3	650
HTW 53'	4' - 5'	PRECAST	#3	650
HTW 74'	6' - 2'	PRECAST	#3	650

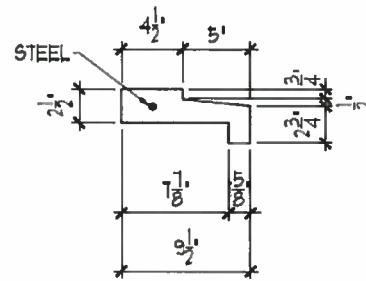

HURRICANE RESISTANT STUCCO SILL				SAFE LATERAL CAPACITY (plf)
	TOTAL SPAN	TYPE	STEEL	
HSTW 19"	1' - 7'	PRECAST	--	650
HSTW 26-1/2'	2' - 2 1/2'	PRECAST	--	650
HSTW 31'	3' - 1'	PRECAST	#3	650
HSTW 48'	4' - 0'	PRECAST	#3	650
HSTW 53'	4' - 5'	PRECAST	#3	650
HSTW 74'	6' - 2'	PRECAST	#3	650

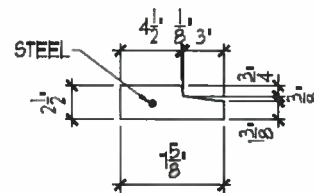

REVISION:	
DATE	DESCRIPTION

CA 25948
 SAMUEL A. GREENBERG, P.E. #34245
 THUY H. HUYNH, P.E. #60122

QUALITY PRECAST COMPANY
 P.O. BOX 11
 Brandon, Florida 33509

SEP 28 2016

ENGINEER SEAL

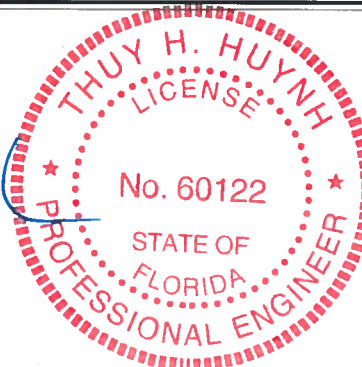

SHEET TITLE:
WINDOW SILL LOAD TABLE

SHEET INFORMATION:
 JOB NO.: 360950
 DATE ISSUED: 9.27.16
 DRAWN BY: JH
 REVIEWED BY: TH

SK2



“Strong” on Service
 P.O. Box 11 Brandon, FL 33509
 Toll Free 800.752.1730
 www.qualityprecast.com

THREE TIER SILL				SAFE LATERAL CAPACITY (plf)
	TOTAL SPAN	TYPE	STEEL	
HRTTS 19'	1' - 7'	PRECAST	--	650
HRTTS 26-1/2'	2' - 2 1/2'	PRECAST	--	650
HRTTS 31'	3' - 1'	PRECAST	#3	650
HRTTS 53'	4' - 5'	PRECAST	#3	650
HRTTS 14"	6' - 2'	PRECAST	#3	650

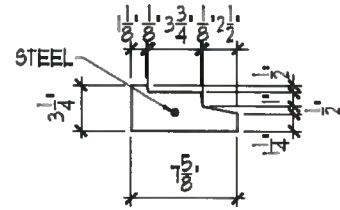

STUCCO THRU WALL SILL				SAFE LATERAL CAPACITY (plf)
	TOTAL SPAN	TYPE	STEEL	
STW 19'	1' - 7'	PRECAST	--	650
STW 26-1/2'	2' - 2 1/2'	PRECAST	--	650
STW 31'	3' - 1'	PRECAST	#3	650
STW 48'	4' - 0'	PRECAST	#3	650
STW 53'	4' - 5'	PRECAST	#3	650
STW 74'	6' - 2'	PRECAST	#3	650

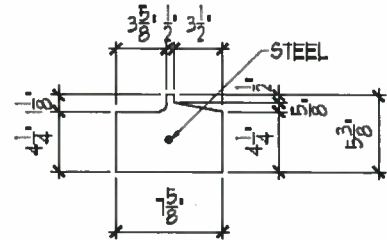

REVISION:

DATE	DESCRIPTION

CA 25948
 SAMUEL A. GREENBERG,
 P.E. #34245
 THUY H. HUYNH,
 P.E. #60122

QUALITY PRECAST COMPANY
 P.O. BOX 11
 Brandon, Florida 33509

SEP 28 2016

Del

ENGINEER SEAL

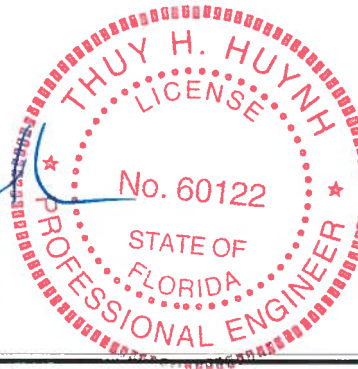

SHEET TITLE:

WINDOW SILL LOAD TABLE

SHEET INFORMATION:

JOB NO.: 360950
 DATE ISSUED: 9.27.16
 DRAWN BY: JH
 REVIEWED BY: TH

SK3